





-  RESERVED FOR WETLAND MITIGATION
-  HARRISON COUNTY OWNED LAND
-  HARRISON COUNTY AVAILABLE LAND
-  PRIVATELY-OWNED LAND



# BILOXI COMMERCE PARK

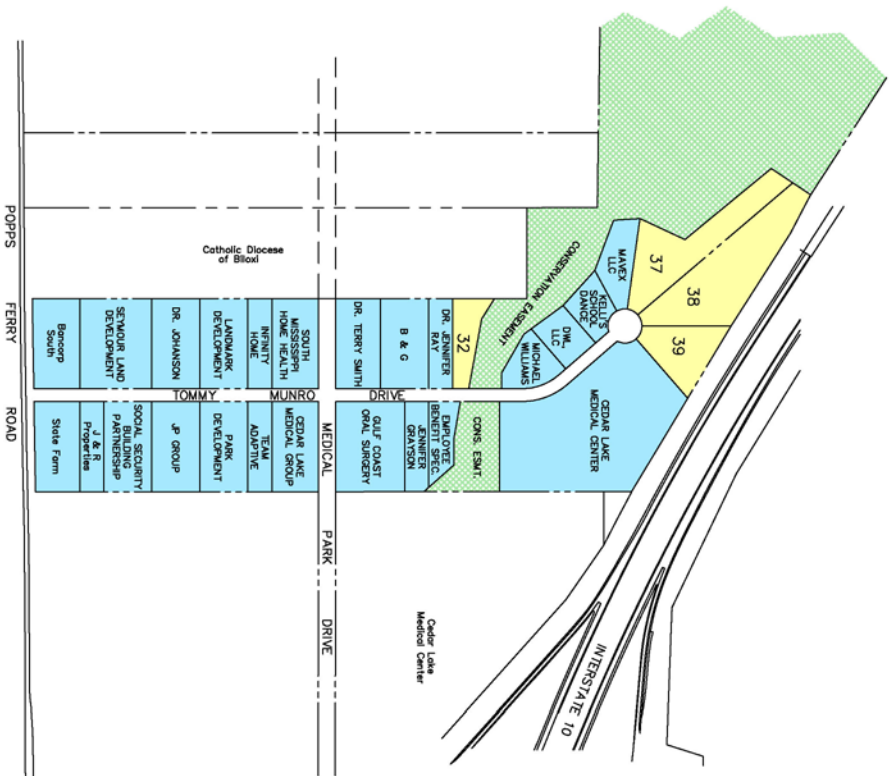

*"Moving the Mississippi Gulf Coast Forward"*  
 12292 Intralux Parkway Gulfport, Mississippi 39503  
 Tel: (228) 896-5020 Fax: (228) 896-6020  
 website: www.mscocast.org

